

Thunderbird

- [Installation of Thunderbird](#)
- [Add Microsoft Outlook Account/Teams to Thunderbird](#)

Installation of Thunderbird

Introduction

Prerequisites

Download the newest Version of Thunderbird directly from their Webpage.

[Download Thunderbird](#)

Installation

Installation on MacOS

Just click on the downloaded .dmg file and copy it to your programs directory.

Installation on Fedora

```
tar -xvzf thunderbird-128.3.0esr.tar.bz2
```

Add Microsoft Outlook Account/Teams to Thunderbird

Introduction

Microsoft 365, Azure or Exchange Server uses a proprietary protocol for E-Mail, Calendar and Contacts/Address Book. It is possible to connect to a Microsoft E-Mail account with Thunderbird. It is also possible to connect to more than one account. Especially if it comes to Teams, which can be used inside of Thunderbird, this feature becomes very useful.

Configuration

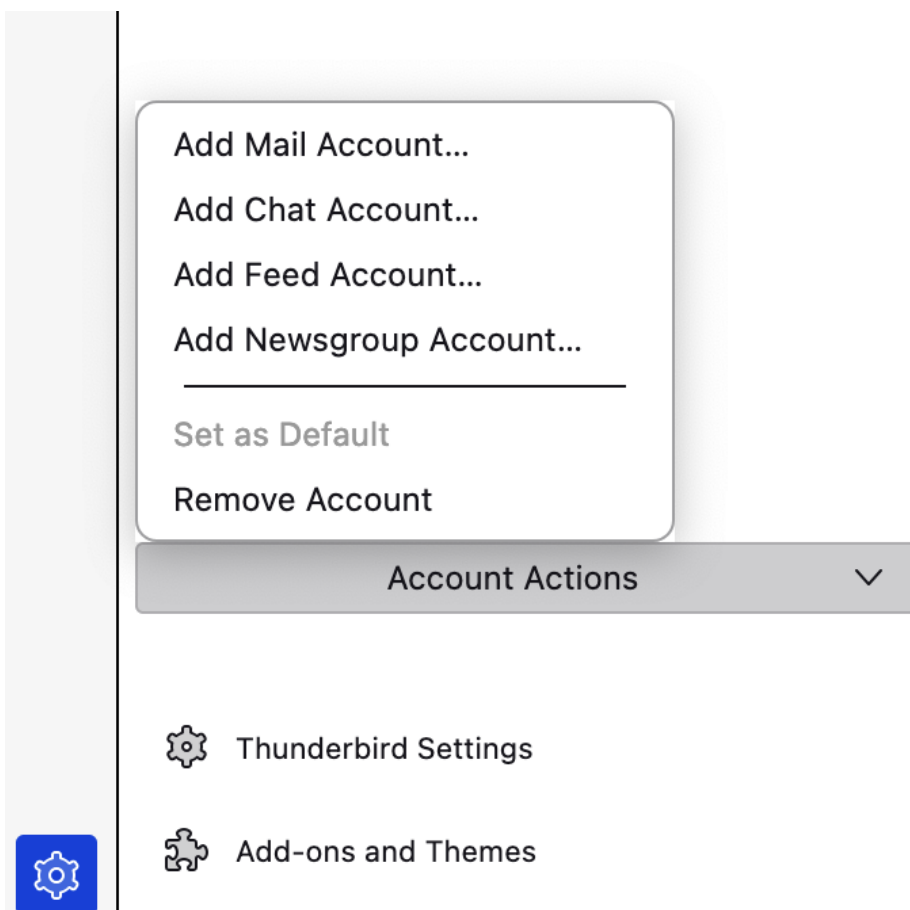

Goto account setting and "Add Mail Account".

Set Up Your Existing Email Address

To use your current email address fill in your credentials.
Thunderbird will automatically search for a working and recommended server configuration.

Your full name

Holger Schindler 

Email address

holger.schindler@securix.swiss 

Password

..... 

Remember password

[Configure manually](#)

Cancel

Continue

Your credentials will only be stored locally on your computer.

You will need your E-Mail address and your password.

After clicking continue, you will be asked to enter your password again. No matter what happens next, you will return to Thunderbird.

✓ Configuration found in Mozilla ISP database.

Available configurations

IMAP
Keep your folders and emails synced on your server

POP3
Keep your folders and emails on your computer

Exchange/Office365
Use the Microsoft Exchange server or Office365 cloud services

 **Server** **SSL/TLS**
outlook.office365.com

[Configure manually](#)

Cancel

Done

Select "Exchange/Office365" and click on "Done".

If you are asked to install "OWL", please do it.

Exchange/Office365

Use the Microsoft Exchange server or Office365 cloud services

 **Server** **SSL/TLS**
outlook.office365.com

This email server unfortunately does not support open protocols. A third-party add-on can allow you to access your email account on this server:



[Owl is a paid add-on that allows you to access your emails on Exchange servers.](#)

Install

Hint

You are now able to use E-Mail and Calendar functionality. So far Contacts/Address book are not working.

Teams:

On the left side you should find the Teams icon. Hover gently over it. It will then show all connected Microsoft Accounts. If you click on one of those account, a new tab will open for teams. Repeat until you opened all the Teams for your tenants.

